



Established 1906

WT KNOWLES & SONS LIMITED

# Construction Products Regulation 305/2011 Declaration of Performance

No. WTK/SFT/KYP59 - KYP60

## Manufacturer

## W T Knowles & Sons Limited

Ash Grove Pipe Works

Elland

West Yorkshire

HX5 9JA

www.wtknowles.co.uk

## Open-Topped Flue Terminal

### Push In 'H' Pot KYP59 - KYP60

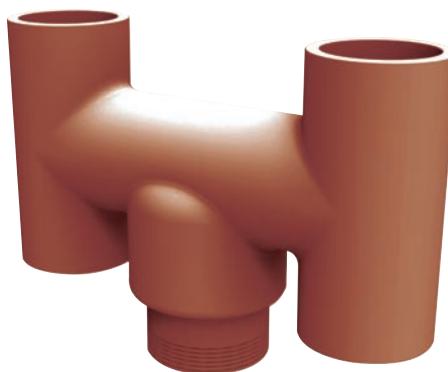

## Dimensions

		KYP59	KYP60
Base:	Outside diameter	185mm	205
	Inside diameter	150mm	175
Top:	Outside diameter	185mm	245
	Inside diameter	150mm	210
Height:	KYP59	KYP60	
	mm	480	480

## Intended Use

To be fixed on an existing chimney pot or flue liner to convey combustion gases from a solid fuel effect fire safely into the atmosphere

## Compliance

Conforms to harmonised standard: BS EN 13502:2002 Type 0 - open-topped flue terminal Annex ZA.1 Attestation of conformity system - 4

## Performance Characteristic

Flow Resistance (K):	NPD
Durability: Freeze/Thaw	Pass - BSI Test Report 8422446
Dangerous Substances:	Not applicable

## Markings

WTK EN 13502 Type 0    CE  
OD / ID / HT    WTK    DATE (DDMMYY)

The performance of the products described above is in conformity with the declared Performance Characteristic when installed and used in accordance with the manufacture's instructions. This declaration is issued under the sole responsibility of the manufacturer.

Signed for and on behalf of the manufacturer by: Martin Knowles

Managing Director

Elland    4<sup>th</sup> June 2018  
Place and Date of Issue